

EXPT

EX-PROOF INTEGRATED P&T MOTORS WITH CAMERA HOUSING



DESCRIPTION

The robust, explosion-proof EXPT pan & tilt range has been designed for use in areas where there is a risk of explosion. They have attained Ex d certification for Zones 1 and 2 (Group IIC for gas) and Ex tb for Zones 21 and 22 for dust. They won't break under stress and are resistant to corrosive particles in the surrounding atmosphere, cleaning agents, saline mist and extremely low temperatures.

The EXPT Pan & Tilt is characterised by the absence of external rotating cables, for easy installation and safe operation of the device.

The Pan & Tilt units EXPT are made with strong Anticorodal aluminium die-cast alloy of AlSi 7Mg EN - AB 42000 group.

The P&T functions are controlled by the EXDTRX telemetry receiver..

CERTIFICATIONS



MAIN FEATURES

Certifications Ex d for use in Zone 1 and 2, Group IIC (Gas), and in Zone Ex tb 21 and 22 (Dust)

Solid anticorodal aluminium construction

Horizontal range 360° with speed 6°/s, vertical range -90° / +90° with speed 2.4°/s

Preset function

Versions with Autopan

7.5m (23ft) prewired multipolar armoured cable

Not to be installed upside down

Ambient temperature: -20°C / +50°C (-4°F / 122°F) or -40°C/+50°C (-40°C/+122°F) with reinforced heater

TECHNICAL DATA

GENERAL

Non-corrosive die-cast aluminium (anticorodal)

Epoxy powder painted with orange peel effect, RAL7032

Ambient temperature: -20°C / +50°C (-4°F / 122°F) or -40°C/+50°C (-40°F/+122°F) with reinforced heater

MECHANICAL

Not to be installed upside down

Horizontal rotation: 0-360°

Horizontal speed (fixed): 6°/s

Pan Torque: 2.5kgm

Vertical plane movement: ±90°

Tilt speed (fixed): 2.4°/s

Vertical torque: 6kgm

Horizontal limit switch adjustable only for the Autopan function

1 cable gland Ex d 3/4" NPT IP66 ATEX for armoured cables in the base of the P&T according the housing marking

Pre-wired multipolar armored cable normally supplied with 7.5m (25ft) length: diameter 21.4mm (0.85in): 21 poles 0.5mm², 6 poles 1.5mm², 2 RG179, 75 Ohm

Minimum bending radius: 10x cable diameter

External dimensions:

- EXPTC 427.5x571.4x560mm (16.8x322.5x22in)

Internal dimensions:

- EXPTC Ø 180x380mm (7x14.9in)

Internal usable area:

- EXPTC 100x100x280mm (3.9x3.9x11in)

Unit weight:

- EXPTC 56.5kg / 124.5lb

Glass window extra clear:

- EXPTC Ø 114mm (4.5in)

ELECTRICAL

Power supply: IN 24Vac, 50/60Hz

Horizontal and vertical motor consumption: 50W max

Consumption: P&T static, heating switched off: 0 W

Standard vertical and horizontal preset potentiometers

Reinforced heater, Ton 10°C±4°C (50°F±7°F), Toff 25°C±3°C (77°F±5°F):

- 3 resistors in the housing
- 2 resistors in the P&T (one for each motor)
- Consumption: 100W max

Devices to install inside the housing:

- Camera equipped with lens with max total power of 20W
- Power supply max 24Vac (only for analog camera)
- Usable volume for camera/lens: 2800cm³
- Minimum distance between the walls of the housing and the camera/lens: 12mm

ENVIRONMENT

For installation indoors and outdoors

Operating temperature with heating: -20°C / +50°C (-4°F / 122°F)

Operating temperature with reinforced heater: -40°C / +50°C (-40°F/+122°F)

Always refer to the temperature in the marking.

Relative humidity: from 10% up to 95% (no condensation)

CERTIFICATIONS

ATEX (EN 60079-0:2012 +A11:2013, EN 60079-1:2014, EN 60079-31:2014):

Ex II 2G Ex d IIC T6 Gb

Ex II 2D Ex t IIIC T85°C Db IP66

IECEx (IEC 60079-0:2011, IEC 60079-1:2014, IEC 60079-31:2013):

Ex d IIC T6 Gb

Ex t IIIC T85°C Db IP66

EAC EX:

Ex d IIC T6 Gb

Ex tb IIIC T85 Db IP66

KCs 16-KA4B0-0059 - 16-KA4B0-0056

Ex d IIC T6

Ex tb IIIC T85°C

ACCESSORIES

EXPTS000 Sunshield 580mm (22.8in) for EXPT series

RELATED PRODUCTS

EXDTRX3 Data telemetry receiver 17 functions, 230Vac

EXDTRX324 Data telemetry receiver 17 functions, 24Vac

BRACKETS AND ADAPTORS

EXPTWB000 Bracket RAL7032 for EXPT series

SPARE PARTS

OEXMYLAR Mylar film replacement kit, 18m (59ft), 350 steps

OEXVETN Complete front flange with glass for EXHC and EXPTC series

OSLIEX Internal slide complete with heater for EXHC and EXPTC series

PACKAGE

Model Number	Weight	Dimensions (WxHxL)	Master carton
EXPTC000	61.2kg (135lb)	76x41x67cm (30x16x26.4in)	-

AVAILABLE MODELS

Model Number	Housing heater 24Vac	Pre-wired multipolar cable	Preset	Autopan	Glass protection device	Ambient temperature
EXPTC000	✓	✓	✓	–	–	-20°C / +50°C (-4°F / 122°F)
EXPTC033R	✓	✓	✓	✓	–	-40°C / +50°C (-40°F / +122°F)

TECHNICAL DRAWINGS

The dimensions of the drawings are in millimetres.

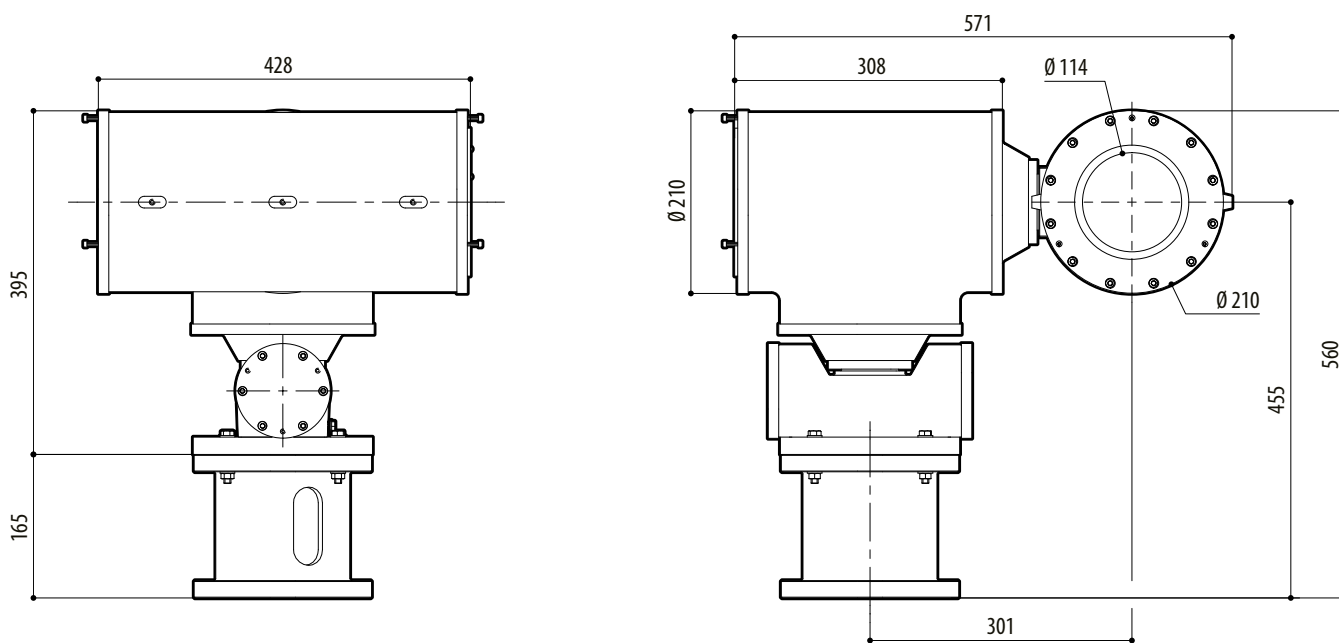

EXPTC